

# CHASE 8™

Precision Pan & Tilt Positioner



Rugged Sensor Stacking Positioner – Shaft Ends PoE – 4KW to Payload  
PATENTS PENDING





Precision Camera/Illuminator High Torque Geo-Pointing  
Vertical & Horizontal Stacking – Radar, Cameras, Lasers, Audio  
Big Power to Payload – Integrated 4 Port Switch, 3 PoE 802.3af

PATENTS PENDING

### Positioner Overview

#### General:

Elegant High Precision & Torque  
Integrated 4 Port Switch, 3 PoE  
High Power Transfer Pan Slip Ring  
Ethernet, RS232, RS422  
Low Power – Low Heat

#### Mechanical:

**Dimensions** 18cm wide  
26cm tall  
32cm deep

**Weight** 5.8Kg

**Payload Capacity** 20Kg Top Flange  
12Kg Right & Left Tilt

**Materials** Alu 6061-T6  
SST 304 & 316  
Silicone Seals  
Kevlar-Urathane Belt  
SST 18-8 Fasteners

#### Electrical:

**MIL X1 Pedestal** DOC 700544  
**MIL T1 Top Flange** DOC 700525  
**MIL C1 Tilt Left** DOC 700527  
**JET Tilt Right** DOC 700528

**COMM** RS232/RS422/Ethernet  
**Network Switch** 4 Port 100BaseT  
Layer 2 Managed  
3 POE Ports, 802.3af

#### Environmental:

2 Grms, 10-2,000 Hz, Ran, 3 axis  
-30° to +65° C (-40° to +75° Opt)  
IP66

### Performance Details

**Pan Movement Range** 360° continuous  
**Pan Encoder Counts/360** >3,600  
**Pan Speed** 0.1 to 60 °/s  
**Pan Accuracy** .1° 2σ  
**Pan Torque** 12NM (25NM Opt)

**Tilt Movement Range** +20° to -40° (±90 Opt)  
**Tilt Encoder Counts/Deg** >10  
**Tilt Speed (Resolution)** 0.1 to 60 °/s  
**Tilt Accuracy** .1° 2σ  
**Tilt Torque** 12NM (25NM Opt)

**Slip Ring Power Transfer** 450W (4kW Opt)  
**Input Power** 24VDC ±3VDC  
**Power Usage** 2.5W typical  
150W at 12NM (2x)

**Health Sensors:**  
**Internal Humidity** 3% to 80% RH, 12Bit  
**Internal Pressure** 50kPa to 115kPa, 12Bit  
**Internal Temperature** -40° to +125° C, 14Bit  
**Servo Status** 32Bit Assignments

### MIL X DEF

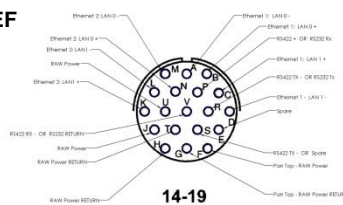

### Mounting Details

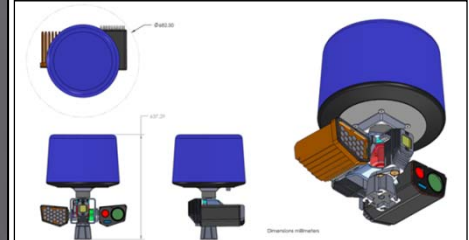
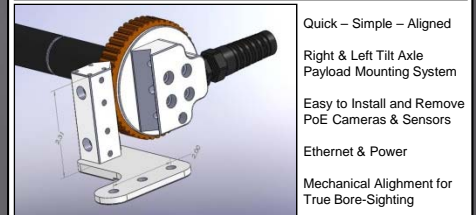
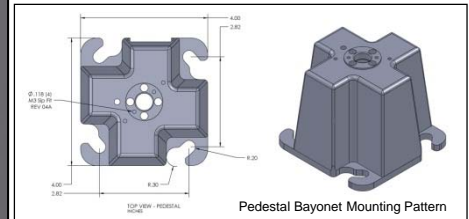

Chase X™ Payload Configuration



### System Software - Integrator Support:

Open Source ASCII Interface  
XML ICD010x Proxy Server  
SDK Third Party Support  
Chase 8™ API – RS232/RS422

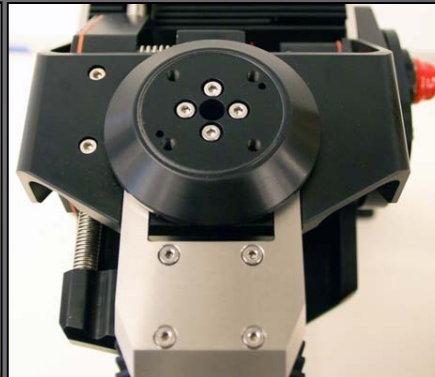

## JETprotect Corporation



### Research / Manufacturing

San Jose International Airport  
2142 Paragon Drive  
San Jose, CA 95131

www.jet-protect.com  
408-562-0001 office  
408-562-0002 facsimile

AUTHORIZED INTEGRATOR & RESELLER